

SOMATOM DEFINITON AS 40/64/128

TYPICAL ROOM PLAN

CT

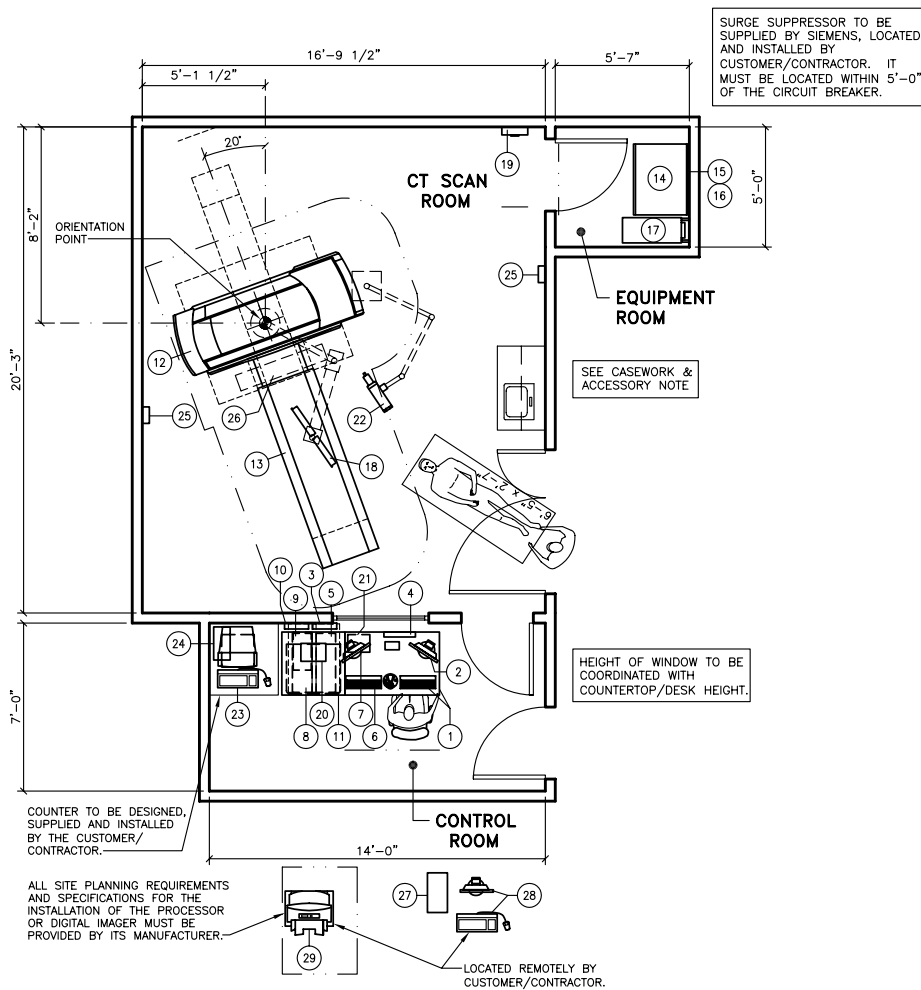

TYPICAL PLAN

SCALE: 1/8" = 1'-0"

SOMATOM DEFINITION AS 40/64/128 SPECIFICATIONS

CT

EQUIPMENT LEGEND								
NO	DESCRIPTION	SMS SYM	WEIGHT (LBS)	BTU/HR TO AIR	DIMENSIONS (INCHES)			REMARKS
					W	D	H	
①	CONTROL CONSOLE W/KEYBOARD AND CONTROL BOX	Ⓝ	75	---	47 1/4	31 1/2	28 3/8	
②	19" FLAT SCREEN MONITOR ICS	Ⓞ	20	256	16 9/16	8 1/4	16 1/16	ON CONSOLE/COUNTER
③	POWER CONNECTION TERMINAL - ICS	Ⓟ	---	---	---	---	---	WALL MOUNTED
④	VIDEO POWER DISTRIBUTION - ICS	Ⓠ	---	---	15 3/4	---	15 9/16	MOUNTED DIRECTLY UNDER CONTROL CONSOLE/COUNTER
⑤	SYNGO ACQUISITION WORKPLACE	Ⓡ	<66	1706	9 13/16	29 1/2	18 1/2	ON FLOOR/IN CONTAINER
⑥	IMAGE EVALUATION KEYBOARD (OPTION)	Ⓢ	-	---	---	---	---	ON CUSTOMER'S COUNTER
⑦	19" FLAT SCREEN MONITOR FOR IES (OPTION)	Ⓣ	20	256	16 9/16	8 1/4	16 1/16	ON CONSOLE/COUNTER
⑧	SYNGO CT WORKPLACE (OPTION)	Ⓤ	<66	1706	9 13/16	29 1/2	18 1/2	ON FLOOR/IN CONTAINER
⑨	UPS FOR IES (OPTION)	Ⓥ	36	171	9 3/16	16 7/16	5 13/16	
⑩	POWER CONNECTION TERMINAL - IES (OPTION)	Ⓦ	---	---	---	---	---	WALL MOUNTED
⑪	CONTAINER & CONTAINER TABLE FOR ICS/IES (OPTION)	Ⓧ	55	---	31 1/2	31 1/2	28 3/8	HOUSING FOR ICS/IES
⑫	SOMATOM DEFINITION AS GANTRY	Ⓨ	4850	3,412*	93 11/16	36 5/8	78	*ADDITIONAL HEAT DISSIPATED TO WATER
⑫	SOMATOM DEFINITION AS GANTRY (OPTION)	Ⓨ	4850	40,946*	93 11/16	36 5/8	78	* AIR COOLED GANTRY
⑬	PATIENT TABLE	Ⓩ	1103	1024	29 1/2	95 11/16	33 7/16	1600mm TABLE
⑭	POWER DISTRIBUTION CABINET & UPS	Ⓩ	1373	6824	35 7/16	27 1/4	76 3/4	UPS LOCATED INSIDE OF PDC
⑮	ETHERNET SWITCH FOR ICS, IRS, GANTRY & PDC'S	Ⓟ	---	---	---	---	---	LOCATED INSIDE PDC
⑯	ETHERNET SWITCH FOR REMOTE IES, DICOM CAMERAS & NETWORK PRINTER	Ⓠ	---	---	---	---	---	LOCATED INSIDE PDC
⑰	IMAGE RECONSTRUCTION SYSTEM - IRSMX2C	Ⓡ	115	3412	12 5/8	29 1/2	20 13/16	WITH 40/64 SLICE CONFIG.
⑰	IMAGE RECONSTRUCTION SYSTEM - IRSMX2B	Ⓡ	126	5118	12 5/8	29 15/16	20 15/16	WITH 128 SLICE CONFIG.
⑱	CARE VISION DUAL MONITOR (OPTION)	Ⓡ	165	512	---	---	---	CEILING MOUNTED
⑲	POWERWARE PXL250 SURGE SUPPRESSOR (OPTION)	Ⓢ	24	---	13	4 1/2	18	WALL MOUNTED
⑳	MEDRAD M2SCT222DF DISPLAY CONTROL UNIT (OPTION)	Ⓣ	8	---	12 1/2	9	13 1/2	HEIGHT WITH SCREEN UP
㉑	MEDRAD M2SCT222DF BASE UNIT (OPTION)	Ⓣ	14	---	11	8 3/4	11 1/2	UNDER COUNTER ON SHELF
㉒	CEILING MOUNTED MEDRAD INJECTOR (OPTION)	Ⓣ	106	---	---	---	---	SEE MFG SPECIFICATIONS
㉓	GAMMEX LASER TRACKING SYSTEM PC (OPTION)	Ⓛ	-	---	---	---	---	SEE MFG SPECIFICATIONS
㉔	GAMMEX LASER CONTROLLER BOX (OPTION)	Ⓛ	-	---	16 1/2	8 1/4	3 1/2	SEE MFG SPECIFICATIONS
㉕	GAMMEX SIDE WALL LASER (2) (OPTION)	Ⓛ	35	---	46 1/16	8 1/4	3 1/2	SEE MFG SPECIFICATIONS
㉖	GAMMEX CEILING LASER (OPTION)	Ⓛ	35	---	46 1/16	8 1/4	3 1/2	SEE MFG SPECIFICATIONS
㉗	MULTIMODALITY WORKPLACE COMPUTER (OPTION)	Ⓛ	55	---	19 3/4	10	23 5/8	ON CUSTOMER'S COUNTER
㉘	MULTIMODALITY WORKPLACE KEYBOARD AND MONITOR (OPTION)	Ⓛ	-	---	---	---	---	ON CUSTOMER'S COUNTER
㉙	LASER CAMERA (OPTION)	Ⓛ	-	---	---	---	---	SEE MFG SPECIFICATIONS

FINISHED ROOM HEIGHT

FOR CT GANTRY ONLY	MINIMUM 7'-6 9/16"
CAREVISION MONITOR/CEILING MOUNT	MIN. 8'-7 1/8" MAX. 12'-0 7/8"

REMOTE SYSTEM DIAGNOSTICS

SIEMENS REMOTE SERVICES (SRS) REQUIRES A CONNECTION BETWEEN THE SRS REMOTE SERVER AND SIEMENS SYSTEMS VIA REMOTE LOCAL AREA NETWORK ACCESS, TO ENSURE THE UPTIME OF YOUR SYSTEM.

THIS SERVICE REQUIRES ONE OF THE FOLLOWING CONNECTION METHODS:

- (PREFERRED) VPN - WHERE THE CUSTOMER HAS AVAILABLE A VPN CAPABLE FIREWALL OR OTHER VPN APPLIANCE.
 - (OPTIONAL) *SRS ROUTER* - CONNECTED TO ANALOG PHONE LINE VIA *ANALOG MODEM*, ETHERNET CONNECTION TO CUSTOMER'S LAN, AND A POWER OUTLET.
- NOTE: = *SUPPLIED BY SIEMENS*

SOMATOM DEFINITION AS 40/64/128 SPECIFICATIONS

CT

POWER REQUIREMENTS				
SYSTEM	LINE VOLTAGE (VOLTS)	POWER CONSUMPTION (KVA)	INCOMING LINE IMPEDANCE (mΩ)	AUTOMATIC CIRCUIT BREAKERS (AMPS)
SOMATOM DEFINITION AS BOKW	3φ 480±10%	NOTE 1	≤ 140	125
<p>NOTE 1</p> <p>POWER CONSUMPTION (WITH STANDARD WATER/WATER HEAT EXCHANGER OR AIR COOLED SYSTEM) OPERATING FOR 6 SEC – 125 kVA OPERATING FOR 100 SEC – 43 kVA SYSTEM ON (STAND-BY) – 4 kVA SYSTEM ON (COMP ON) – 2.5 kVA GANTRY OFF (EVA ON) – 1.7 kVA</p> <p>POWER CONSUMPTION (WITH OPTIONAL WATER/AIR SPLIT COOLING SYSTEM) OPERATING FOR 6 SEC – 135 kVA OPERATING FOR 100 SEC – 53 kVA SYSTEM ON (STAND-BY) – 14 kVA SYSTEM ON (COMP ON) – 2.5 kVA GANTRY OFF (EVA ON) – 1.7 kVA</p> <p>IF AN ON-SITE PRE-TRANSFORMER IS REQUIRED, IT MUST BE A MIN. OF 160 KVA. ALL STANDARD COMPONENTS AND ADD-ONS ARE SUPPLIED VIA THE POWER DISTRIBUTION SYSTEM. DO NOT CONNECT NON-SIEMENS COMPONENTS SUCH AS LASER CAMERAS OR FILM PROCESSORS TO THE SIEMENS POWER DISTRIBUTION SYSTEM (PDS).</p> <p>THE EXAMINATION ROOM SHOULD BE EQUIPPED WITH AT LEAST ONE EMERGENCY POWER OFF (PANIC) BUTTON. TO ENSURE SATISFACTORY SYSTEM OPERATION THE PDS MUST HAVE A DEDICATED PROTECTIVE GROUND CONDUCTOR.</p>				

CASEWORK & ACCESSORY NOTES
<p>1) ALL CASEWORK IS EITHER EXISTING OR IS TO BE DESIGNED, DETAILED, FURNISHED AND INSTALLED BY THE CUSTOMER AND/OR CONTRACTOR. FOLLOW DESIGN RECOMMENDATIONS INCLUDED HERewith, AS THEY ARE ESSENTIAL FOR THE SUCCESSFUL INSTALLATION & OPERATION OF THE SIEMENS EQUIPMENT.</p> <p>2) ALL FURNITURE (CHAIRS, ETC.) FOR THE CONTROL ROOM ARE TO BE PROVIDED BY THE CUSTOMER.</p>

CHILLED WATER
<p>THE GANTRY IS COOLED WITH CHILLED WATER IN A CLOSED LOOP CONNECTION FROM THE ON-SITE CHILLED WATER SUPPLY. AN ON-SITE CONNECTION TO THE CHILLED WATER SUPPLY MUST BE AVAILABLE TO SUPPLY THE HEAT EXCHANGER LOCATED INSIDE THE GANTRY. THE REQUIRED WATER TEMPERATURE IS 39.2 TO 53.6°F. THE NOMINAL OPERATING PRESSURE IS 29 TO 87 PSI, (MAX. 145 PSI). THE MINIMUM FLOW RATE DEPENDS ON THE WATER TEMPERATURE. DIFFERENTIAL PRESSURE AS RELATES TO WATER CIRCULATION. HEAT DISSIPATION INTO THE WATER IS 40,946 BTU/HR.</p>

AIR-COOLED GANTRY
<p>THE AIR-COOLED GANTRY HAS INTEGRATED COOLING FANS FOR AIR INTAKE AND AIR EXHAUST. ROOM AIR IS USED AS COOLING AIR. THE REQUIRED AIR INTAKE TEMPERATURE IS 64.4 TO 82.4°F. THE REQUIRED AIR FLOW RATE THROUGH THE GANTRY IS 81,224 CUBIC FEET/HOUR. HEAT DISSIPATION INTO THE AIR IS 40,946 BTU/HR. BECAUSE OF SHORT-TERM COOLING PEAKS, THE AIR CONDITIONER FOR THE SCAN ROOM WHERE GANTRY HEAT IS DISSIPATED MUST HAVE A MINIMUM 68,243 BTU/HOUR OF POWER.</p>

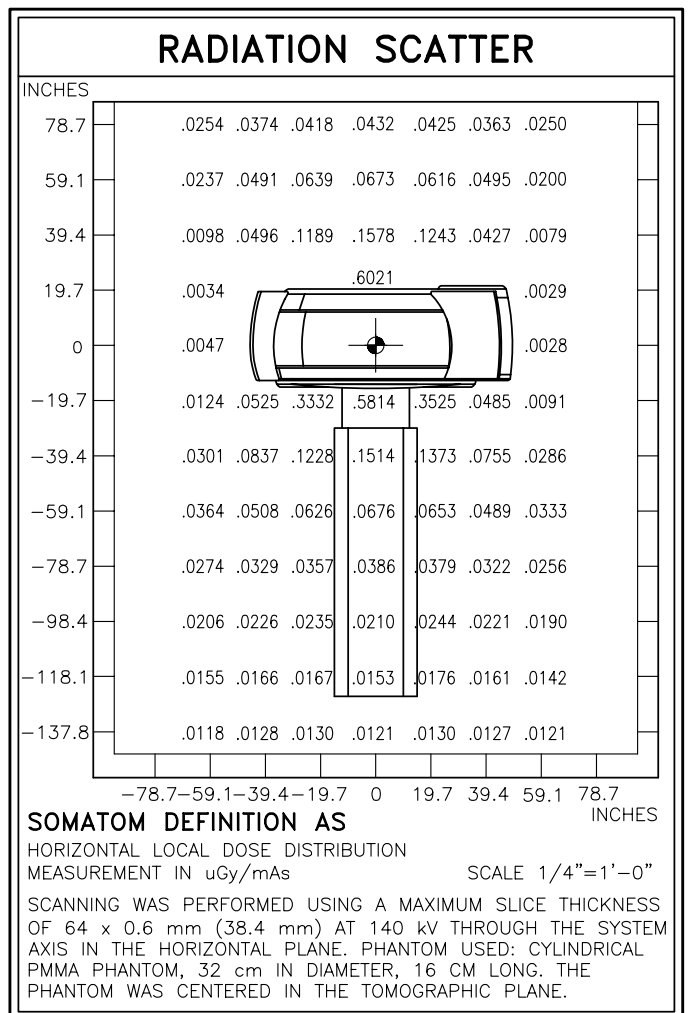

SOMATOM DEFINITION AS 40/64/128 SPECIFICATIONS

CT

